

AXIAL FAN ANCILLARIES

MATCHING FLANGES & FLEXIBLE CONNECTIONS

For flexible coupling between fan and ducting. Standard Flexible connections are 'acoustic' type to reduce noise break out. They are suitable for operation up to 60 deg C continuous. High temperature flexibles are suitable for operation at 200 deg C continuous or for emergency smoke exhaust at 300 deg C for two hours. They are held in position with a clamping band.

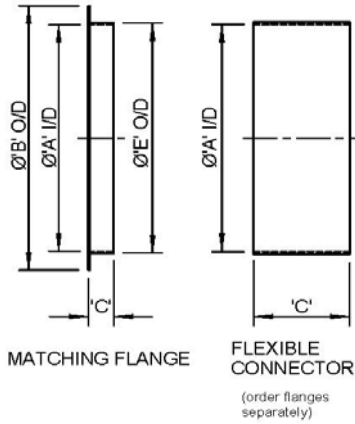

Fan Size	Matching Flanges				Flex Connection		Flange Detail		
	A	B	C	E	A	C	G (no)	H (dia)	I (pcd)
250	253	300	30	256	258	200	4	10	280
315	318	375	30	321	321	200	8	10	355
400	403	475	30	406	405	200	8	12	450
450	453	525	30	456	456	200	8	12	500
500	503	585	40	506	505	200	12	12	560
560	563	645	40	566	565	200	12	12	620
630	633	715	40	636	636	200	12	12	690
710	714	795	40	724	722	200	16	12	770
800	804	885	40	814	812	200	16	12	860
900	904	1000	50	914	912	200	16	15	970
1000	1004	1100	50	1014	1015	200	16	15	1070
1120	1124	1220	50	1134	1138	200	20	15	1190
1250	1254	1350	50	1264	1268	200	20	15	1320

MOUNTING FEET & ANTI VIBRATION MOUNTS

Matched to fan size and weight to give optimum vibration isolation. Feet are manufactured from mild steel and zinc plated or galvanised finish.

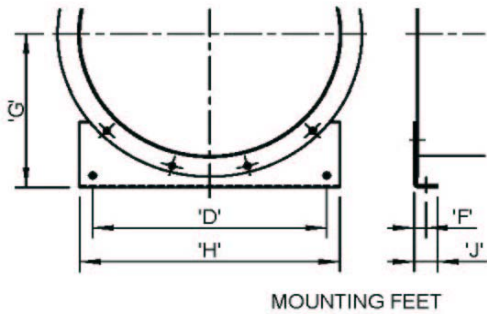

Size	Feet					
	D	F	G	H	J	Hole Dia
250	200	18	165	250	30	10
315	265	23	200	315	35	10
400	350	22.5	245	400	35	12
450	400	25	270	450	40	12
500	450	27.5	315	500	45	12
560	510	27	355	560	45	12
630	580	27	380	630	45	12
710	640	27	420	710	55	12
800	730	34.5	470	800	55	12
900	800	34.5	530	900	55	15
1000	900	30	580	1000	55	15
1120	1020	30	670	1120	55	15
1250	1150	30	735	1250	55	15

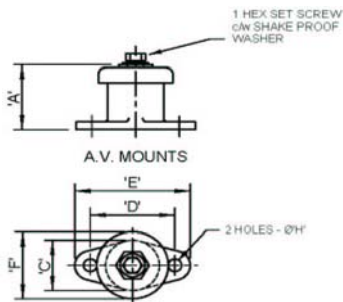

Type	Anti Vibration Mounts								
	A	C	D	E	F	G	H	Matl	Max kg
AVM1	19	38	49.2	62	26	M8	4.8	Rubber	15
AVM2	28	60	73	92	37	M8	8	Rubber	36
AVM3	50	38	64	88	52	M8	10.2	Alum	52
AVM4	86	70	114	150	93	M12	13	Alum	190
ES20	63	38	54	76	48	M8	6.5	Steel	70
ES25	88	70	85	110	78	M10	8.7	Steel	250
SH20	100	40	n/a	55	n/a	M10	n/a	Steel	70

ES20 & 25 are suitable for smoke extract applications.

AXIAL FAN ANCILLARIES

INLET CONES

When the fan is situated at the inlet of a duct (eg smoke pressurisation for stairwell) an inlet cone will reduce the airflow losses for the air inlet. Manufactured in galvanised steel.

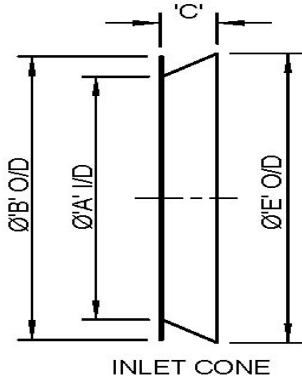

Inlet Cone					
Size	A	B	C	E	kg
250	254	333	70	335	3
315	319	398	75	400	5
400	404	483	80	490	9
450	454	530	80	540	12
500	504	588	85	600	14
560	562	642	100	670	16
630	635	715	110	755	18
710	714	797	125	858	24
800	800	885	140	960	28
900	901	1003	150	1080	37
1000	1001	1103	180	1210	42
1120	1120	1226	200	1350	45
1250	1250	1356	220	1510	50

BUTTERFLY DAMPERS

Non-return gravity dampers to prevent reverse flow through the duct when the fan is idle. Manufactured in pre galvanised steel.

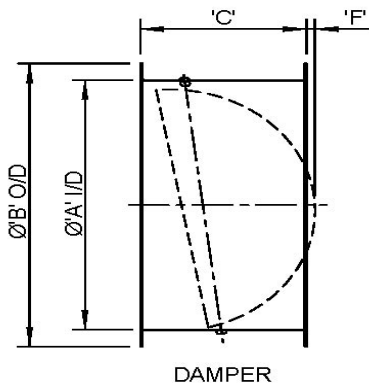

Damper					
Size	A	B	C	F	kg
250	250	335	350	0	6
315	319	375	350	0	8
400	403	475	350	0	11
450	450	540	350	0	14
500	503	585	350	0	18
560	562	645	350	10	20
630	634	715	350	50	23
710	714	795	350	90	29
800	804	885	350	120	36
900	905	1000	350	170	55
1000	1005	1100	350	230	67
1120	1126	1220	350	570	80
1250	1256	1350	350	635	90

OUTLET HOODS

At the discharge end of the duct an outlet hood with a bird mesh guard can be fitted to give weather protection and a neat termination. Manufactured in galvanised steel.

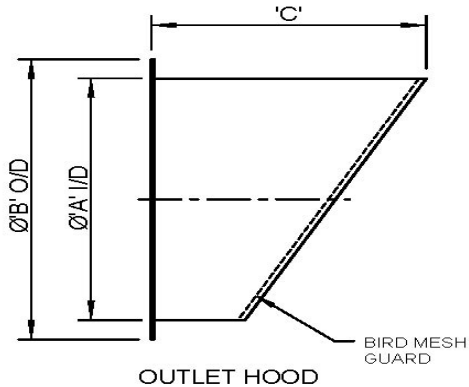

Outlet Hood				
Size	A	B	C	kg
250	250	300	230	5
315	315	375	265	8
400	400	475	350	16
450	450	525	400	18
500	500	585	440	19
560	560	645	490	22
630	633	715	550	26
710	710	795	620	35
800	804	885	700	44
900	900	1000	790	53
1000	1000	1100	880	65
1120	1126	1220	947	95
1250	1250	1350	1000	105